

# ASSEMBLY INSTRUCTIONS

Thank you for purchasing this quality product. Be sure to check all packing materials carefully for small parts that have come loose inside the carton during shipment.

\*\*\*Caution: Please read all instructions carefully before starting the assembly process. These parts are cumbersome and heavy. Therefore, two people are recommended in order to prevent personal injury and ensure the parts are not damaged during the assembly process.

## COMPONENT PARTS

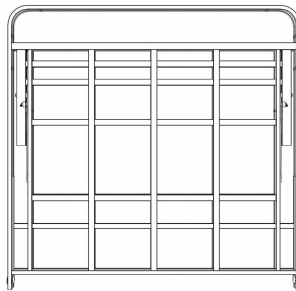

Twin\*1PC  
Full & Queen & King\*2PCS

## ASSEMBLY INSTRUCTIONS

### Twin

Step 1: Unfold the unit from the center and lay flat.

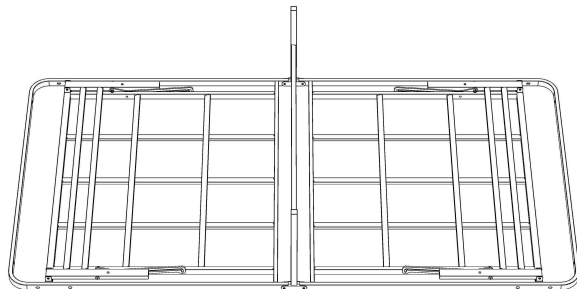

Step 2: Raise all six legs to the upright position. Each of the four end legs have connect support arms.

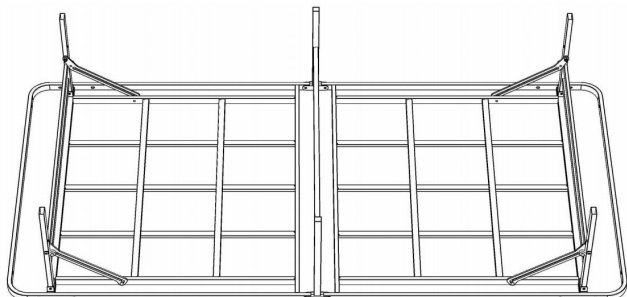

Step 3: Pull-up the support arms to hook onto the bolts .No need any tools and any components to assemble .

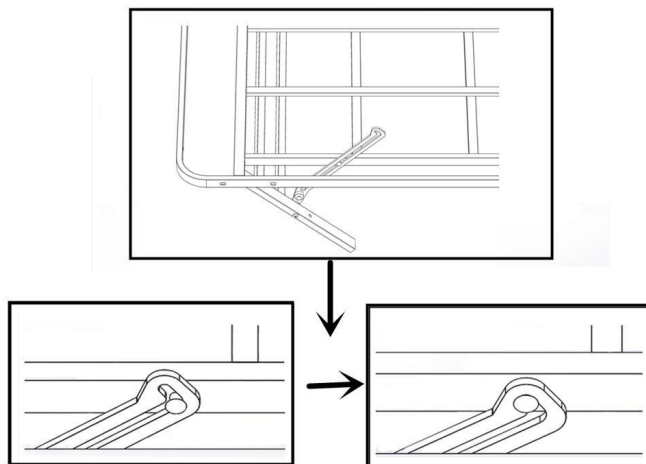

Step 4: Turn over frame. Your twin frame is complete

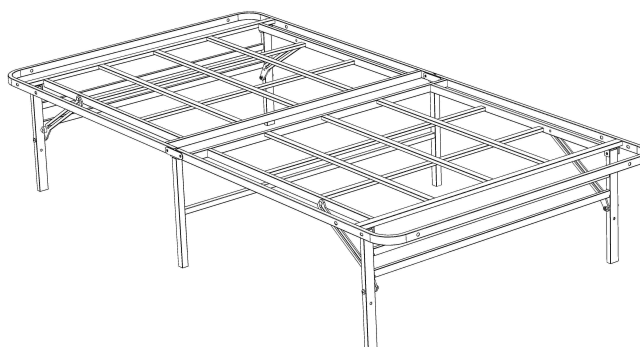

## Full/Queen/King

Repeat steps 1 - 4 as above for both base units, then attach the two units together.

Step 5: Insert two halves together with keyhole locked in place.

